

COPAL

LB16-120-BA 16mm Brushless Gear Motor 6Vdc, 120:1 Ratio

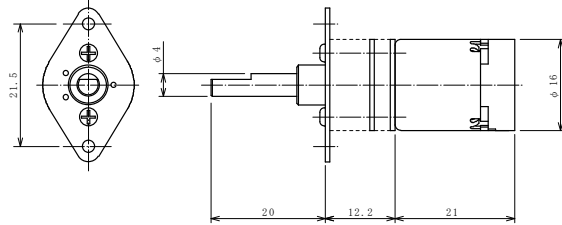

Drive Electronics :Internal
 Gearbox :Metal Gears
 Bearing Type :Sleeve
 Rotation :CW; CCW
 Operating Temp :0°C~50°C
 Net Weight :24g

Model	Rated Voltage (Vdc)	Operating Voltage (Vdc)	Rated Current (mA)	Starting Current (mA)	Rated Torque		Starting Torque		Rated Speed (rpm)	No Load Speed (rpm)	Sound Level (dBA)
					oz-in	mNm	Oz-in	mNm			
LB16-120-BA	6	5.4~6.6	220	800	4.8	34	31	220	67	77	45

Sound levels measured at 0.3 meters from the motor case

●Performance Curves

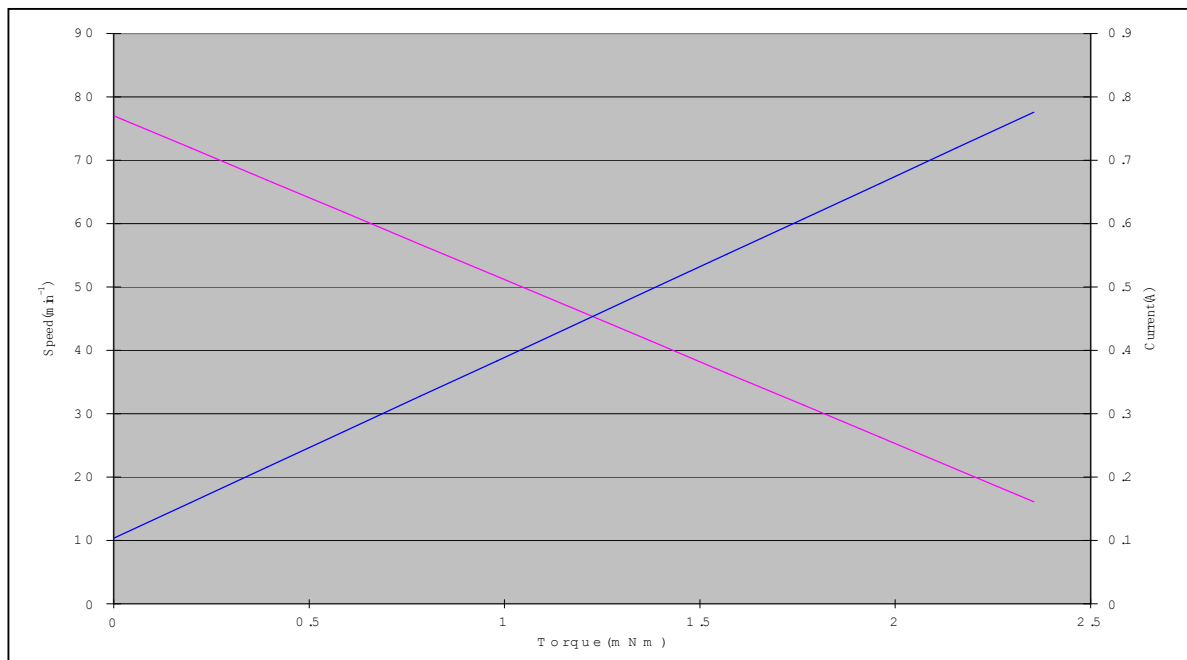

Input/Output Signal

Wire No.	Item	Standard	Wire Color
1	GND		Black
2	VM (Motor Power)	3.5~6.6VDC (Motor Speed Control)	Gray
3	Vcc (driver circuit)	6VDC (5.4~6.6VDC)	Red
4	Rotation direction	CW: to GND: CCW: to Vcc	Green
5	FG (Hall output)	P-P:GND to Vcc 484P/R (Gear Ratio×4) Square wave signal	Yellow

Nidec Copal (U.S.A.) Corporation

373 Van Ness Ave Suite 130

Torrance, CA 90501

Tel: (310) 782-6102

Fax: (310) 782-6821

www.nidec-copal-usa.com

info@nidec-copal-usa.com