

# COPAL

## LB16MG-300-CA 16mm Brushless Motor Planetary Metal Gearbox 6Vdc, 300:1 Ratio

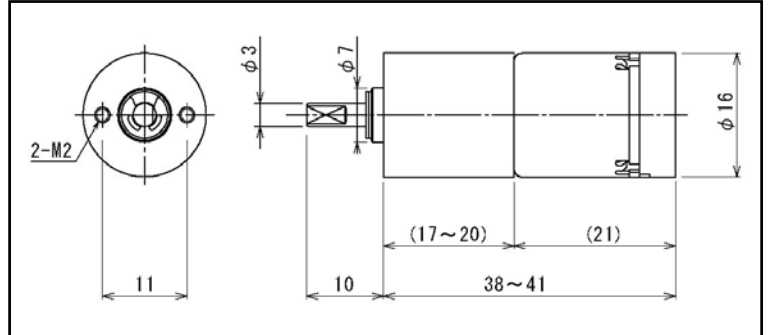

Drive Electronics :Internal  
 Gearbox :Planetary Metal Gears  
 Bearing Type :Sleeve  
 Rotation :CW; CCW  
 Operating Temp :0°C~50°C  
 Net Weight :33.5g

Model	Rated Voltage (Vdc)	Rated Current (mA)	Starting Current (mA)	Rated Torque		Starting Torque		Rated Speed (rpm)	No Load Speed (rpm)	Length (mm)
				oz-in	mNm	oz-in	mNm			
LB16MG-300-CA	6	330	1100	18	127.4	81	570	34	25	41

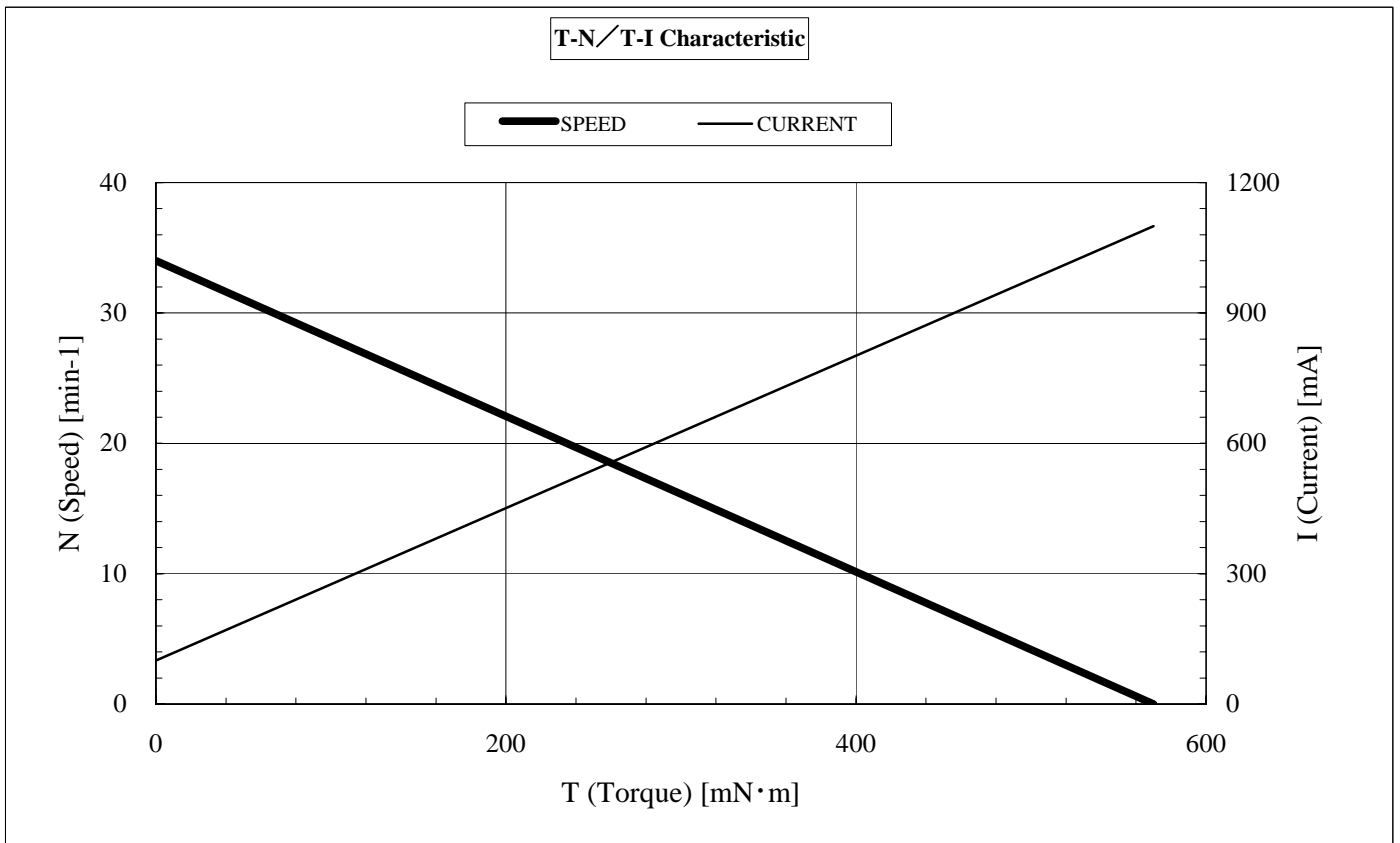

## Input/Output Signal

Wire No.	Item	Standard	Wire Color
1	GND		Black
2	VM (Motor Power)	3.5~6.6VDC (Motor Speed Control)	Gray
3	Vcc	6VDC: (5.4~6.6VDC)	Red
4	CW/CCW	CW: to Vcc; CCW: to GND	Green
5	FG	P-P: GND to Vcc 1216 P/R (Gear Ratio×4) Square wave signal	Yellow

### Nidec Copal (U.S.A.) Corporation

373 Van Ness Ave Suite 130

Torrance, CA 90501

Tel: (310) 782-6102

Fax: (310) 782-6821

[www.nidec-copal-usa.com](http://www.nidec-copal-usa.com)

[info@nidec-copal-usa.com](mailto:info@nidec-copal-usa.com)