

COPAL

37mm Gear Motor HG37 Series 30:1 Ratio

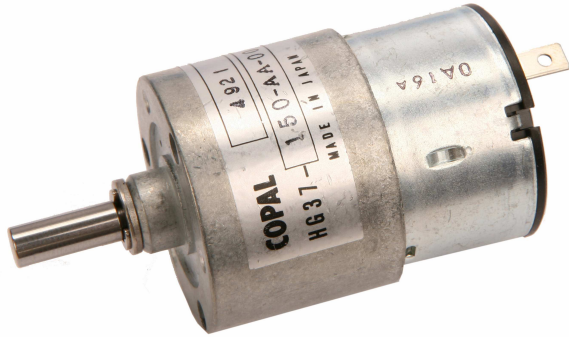

Case : Metal
 Bearing : Sleeve Bearing
 Operating Temp : 0°C~50°C
 Rotation : CW, CCW
 Net Weight : 150g

- Resin gears for quiet operation
- Planetary Gearbox
- Special configurations available upon request
- RoHS Compliant

Model	Rated Voltage (DC)	Operating Voltage (DC)	Rated Current (mA)	Stall Current (mA)	Rated Torque		Stall Torque		Rated Speed (rpm)	No Load Speed (rpm)
					oz-in	N-cm	oz-in	N-cm		
HG37-030-AA	12	10.8~13.2	350	1500	13.9	9.8	55.5	51.9	140	173
HG37-030-AB	24	21.6~26.4	200	750						

OUTLINE DIMENSIONS

(Unit: mm)

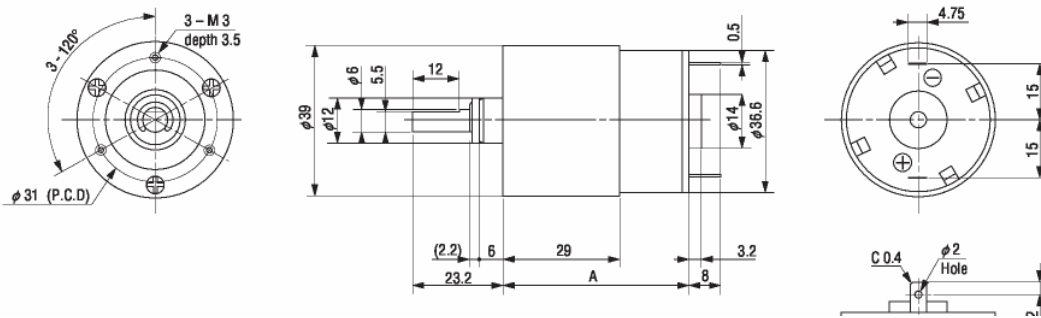

A = 46.5mm

Nidec Copal (U.S.A.) Corp.
 373 Van Ness Ave Suite 130
 Torrance, CA 90501
 Tel: (310) 782-6102
 Fax: (310) 782-6821
 www.nidec-copal-usa.com
 info@nidec-copal-usa.com

