

COPAL

LB16-050-BA 16mm Brushless Gear Motor 6Vdc, 50:1 Ratio

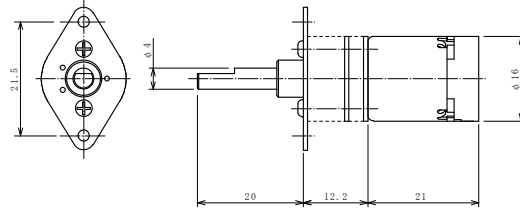

Drive Electronics : Internal
Gearbox : Metal Gears
Bearing Type : Sleeve
Rotation : CW; CCW
Operating Temp : 0°C~50°C
Net Weight : 24g

Model	Rated Voltage (Vdc)	Operating Voltage (Vdc)	Rated Current (mA)	Starting Current (mA)	Rated Torque		Starting Torque		Rated Speed (rpm)	No Load Speed (rpm)	Sound Level (dBA)
					oz-in	mNm	oz-in	mNm			
LB16-050-BA	6	5.4~6.6	250	800	2.8	20	11.9	84	177	213	45

Sound levels measured at 0.3 meters from the motor case

● Performance Curves

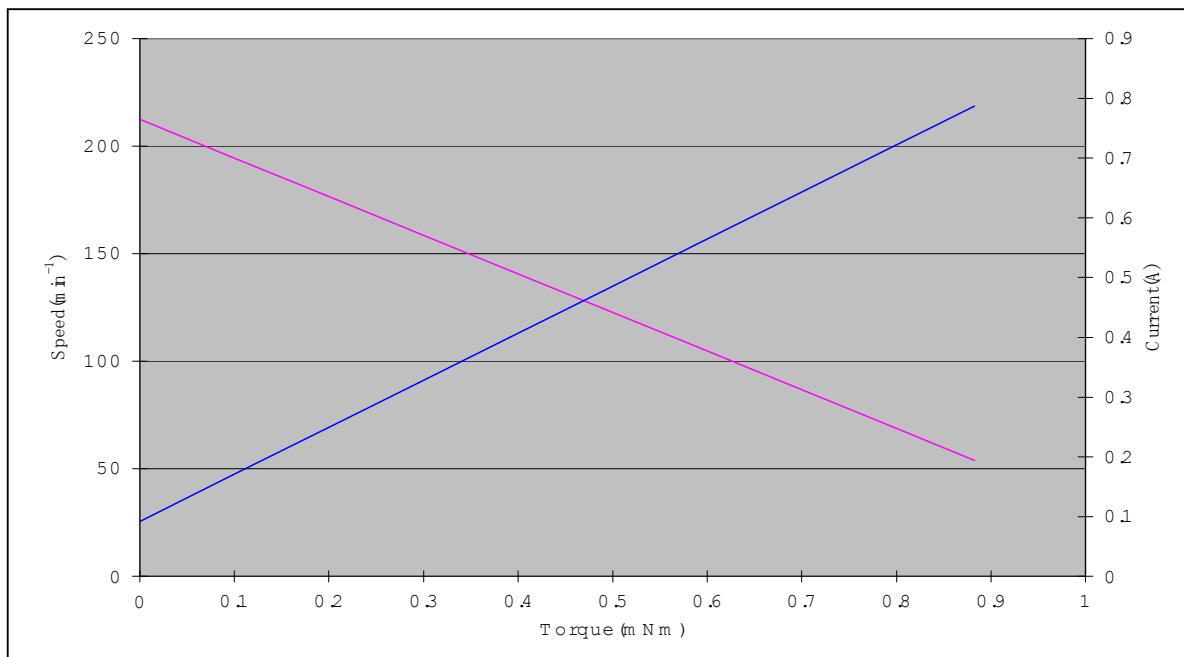

Input/Output Signal

Wire No.	Item	Standard	Wire Color
1	GND		Black
2	VM (Motor Power)	3.5~6.6VDC (Motor Speed Control)	Gray
3	Vcc (driver circuit)	6VDC (5.4~6.6VDC)	Red
4	Rotation direction	CW: to GND; CCW: to Vcc	Green
5	FG (Hall IC output)	200P/R (Gear Ratio × 4) Square wave signal	Yellow

Nidec Copal (U.S.A.) Corporation

373 Van Ness Ave Suite 130

Torrance, CA 90501

Tel: (310) 782-6102

Fax: (310) 782-6821

www.nidec-copal-usa.com

info@nidec-copal-usa.com