

COPAL

LB16-050-BB 16mm Brushless Gear Motor 12Vdc, 50:1 Ratio

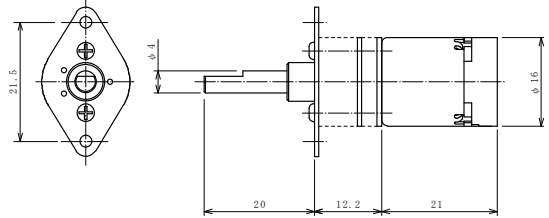
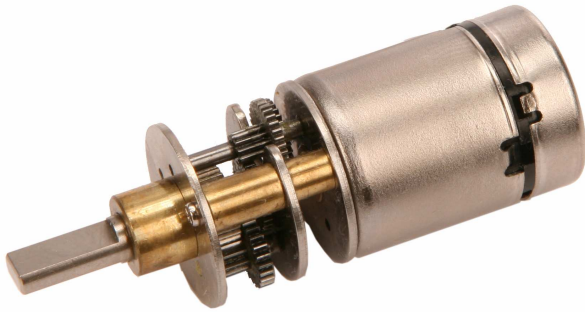

Drive Electronics : Internal
Gearbox : Metal Gears
Bearing Type : Sleeve
Rotation : CW; CCW
Operating Temp : 0°C~50°C
Net Weight : 24g

Model	Rated Voltage (Vdc)	Operating Voltage (Vdc)	Rated Current (mA)	Starting Current (mA)	Rated Torque		Starting Torque		Rated Speed (rpm)	No Load Speed (rpm)	Sound Level (dBA)
					oz-in	mNm	oz-in	mNm			
LB16-050-BB	12	10.8~13.2	180	800	2.8	20	19.8	140	239	266	45

Sound levels measured at 0.3 meters from the motor case

● Performance Curves

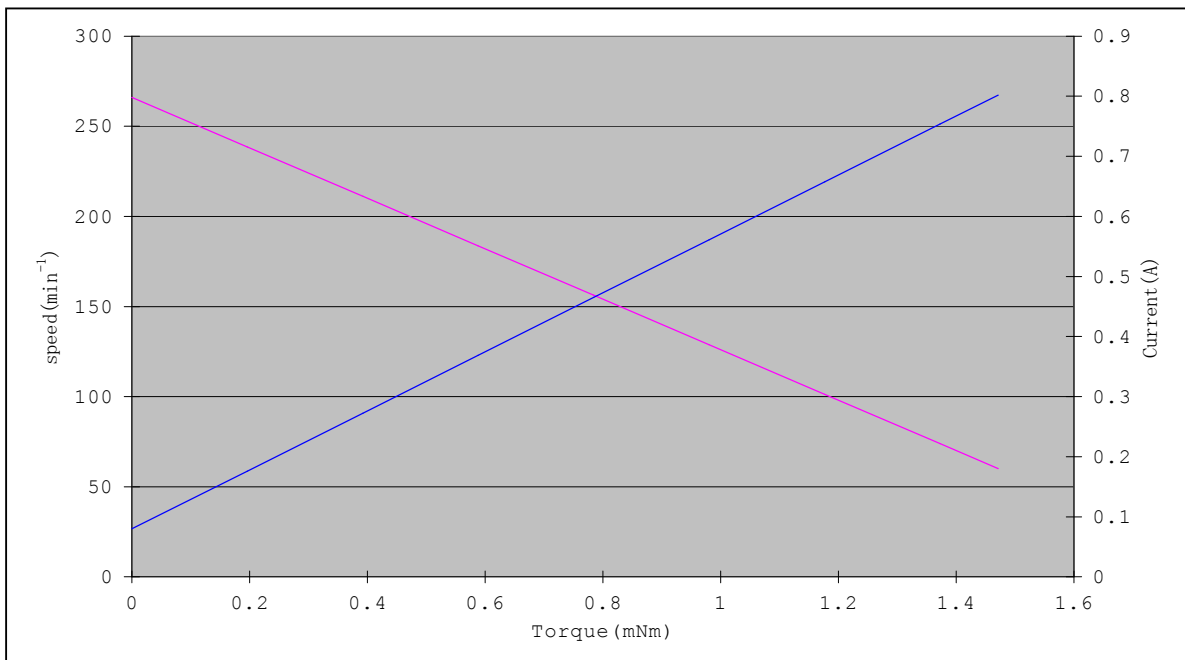

Input/Output Signal

Wire No.	Item	Standard	Wire Color
1	GND		Black
2	VM (Motor Power)	3.5~13.2VDC (Motor Speed Control)	Gray
3	Vcc (driver circuit)	12VDC (10.84~13.2VDC)	Red
4	Direction of rotation	CW: to GND; CCW: to Vcc	Green
5	FG (Hall output)	200P/R (Gear Ratio×4) Square wave signal	Yellow

Nidec Copal (U.S.A.) Corporation
373 Van Ness Ave Suite 130
Torrance, CA 90501
Tel: (310) 782-6102
Fax: (310) 782-6821
www.nidec-copal-usa.com
info@nidec-copal-usa.com