

COPAL

LB16-120-BB 16mm Brushless Gear Motor 12Vdc, 120:1 Ratio

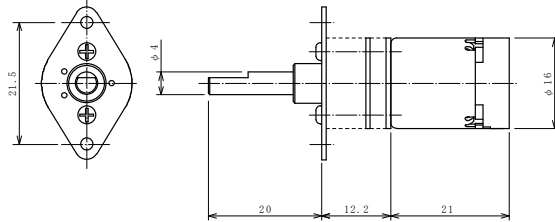

Drive Electronic :Internal
 Gearbox :Metal Gears
 Bearing Type :Sleeve
 Rotation :CW; CCW
 Operating Temp :0°C~50°C
 Net Weight :24g

Model	Rated Voltage (Vdc)	Operating Voltage (Vdc)	Rated Current (mA)	Starting Current (mA)	Rated Torque		Starting Torque		Rated Speed (rpm)	No Load Speed (rpm)	Sound Level (dBA)
					oz-in	N-cm	Oz-in	N-cm			
LB16-120-BB	12	10.8~13.2	130	800	3.47	2.45	49.5	35	100	110	45

Sound levels measured at 0.3 meters from the motor case

●Performance Curves

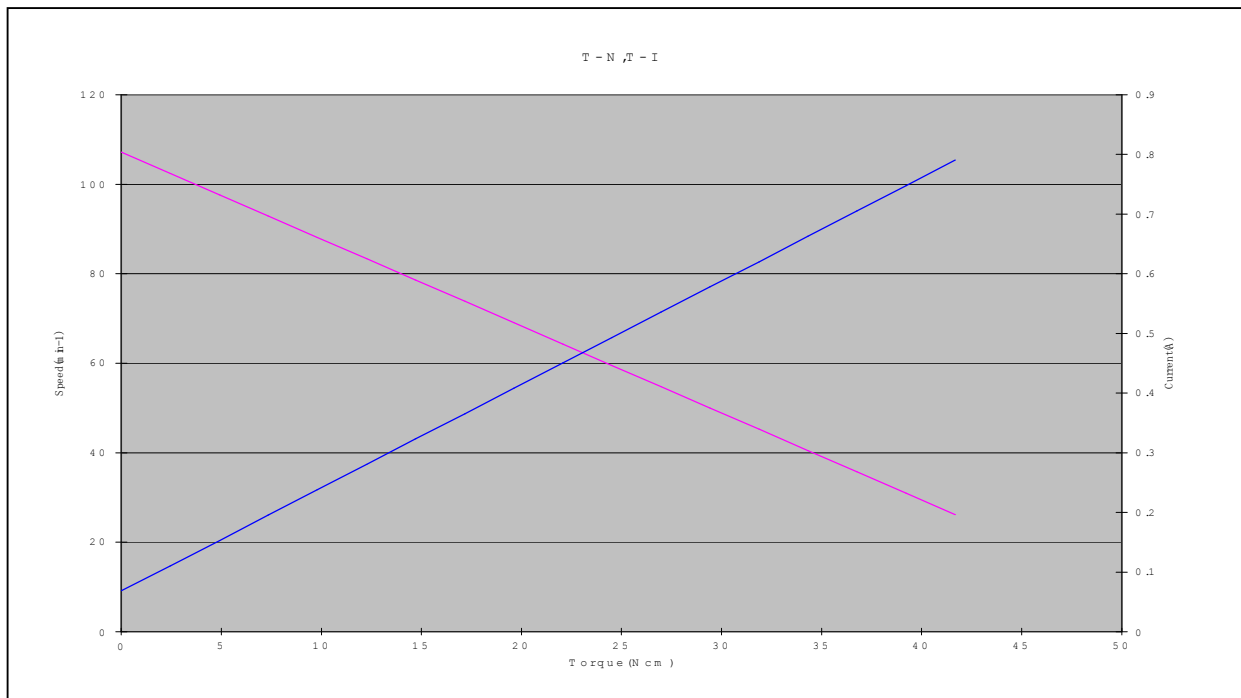

Input/Output Signal

Wire No.	Item	Standard	Wire Color
1	GND		Black
2	VM(Motor Power)	3.5~13.2VDC (Motor Speed Control)	Gray
3	Vcc (driver circuit)	12VDC (10.8~13.2VDC)	Red
4	Rotation direction	CW: to GND; CCW: to Vcc	Green
5	FG (Hall output)	484 P/R (Gear Ratio×4) Square wave signal	Yellow

Nidec Copal (U.S.A.) Corporation
373 Van Ness Ave Suite 130
Torrance, CA 90501
Tel: (310) 782-6102
Fax: (310) 782-6821
www.nidec-copal-usa.com
info@nidec-copal-usa.com